

# REPLACEMENT OF BRIDGE SAL-102-1.99 ON BEHLEMAN ROAD, TR#102, WITH A CONCRETE BOX CULVERT LOCATED IN SECTIONS 33 & 34, T7N,R15E, SALEM TOWNSHIP, OTTAWA COUNTY, OHIO, 2011

## QUANTITIES

ITEM	QUANTITY	UNITS	DESCRIPTION
ROADWAY			
1-202	LUMP	SUM	STRUCTURE REMOVED
2-202	150	SQ YD	PAVEMENT REMOVED
3-202	95	FT	PIPE REMOVED, 24" AND UNDER
4-202	40	FT	PIPE REMOVED FOR REUSE, 24" AND UNDER
5-204	150	SQ YD	SUBGRADE COMPACTION
EROSION CONTROL			
6-601	25	CU YD	ROCK CHANNEL PROTECTION, TYPE C WITH FABRIC FILTER
7-659	470	SQ YD	SEEDING AND MULCHING
8-659	0.06	TON	COMMERCIAL FERTILIZER
9-659	0.1	ACRE	LIME
10-659	2	M GAL	WATER
11-832	500	EACH	EROSION CONTROL
PAVEMENT			
12-301	23	CU YD	ASPHALT CONCRETE BASE, PG64-22
13-304	53	CU YD	AGGREGATE BASE
14-407	11	GAL	TACK COAT
15-407	6	GAL	TACK COAT FOR INTERMEDIATE COURSE
16-408	55	GAL	PRIME COAT
17-411	10	CU YD	STABILIZED CRUSHED AGGREGATE
18-448	7	CU YD	ASPHALT CONCRETE INTERMEDIATE COURSE, TYPE 2, PG64-22
19-448	5	CU YD	ASPHALT CONCRETE SURFACE COURSE, TYPE 1, PG64-22
DRAINAGE			
20-603	32	FT	15" CONDUIT, TYPE B
21-603	88	FT	15" CONDUIT, TYPE C
22-603	40	FT	12" CONDUIT, TYPE C, AS PER PLAN
23-603	72	FT	13' X 6' CONDUIT, TYPE A, 706.05
24-604	1	EACH	CATCH BASIN, NO. 2-2B
TRAFFIC CONTROL			
25-614	LUMP	SUM	DETOUR SIGNING
26-642	0.02	MILE	EDGE LINE
27-642	0.01	MILE	CENTER LINE
INCIDENTALS			
28-614	LUMP	SUM	MAINTAINING TRAFFIC
29-623	LUMP	SUM	CONSTRUCTION LAYOUT STAKING
30-624	LUMP	SUM	MOBILIZATION

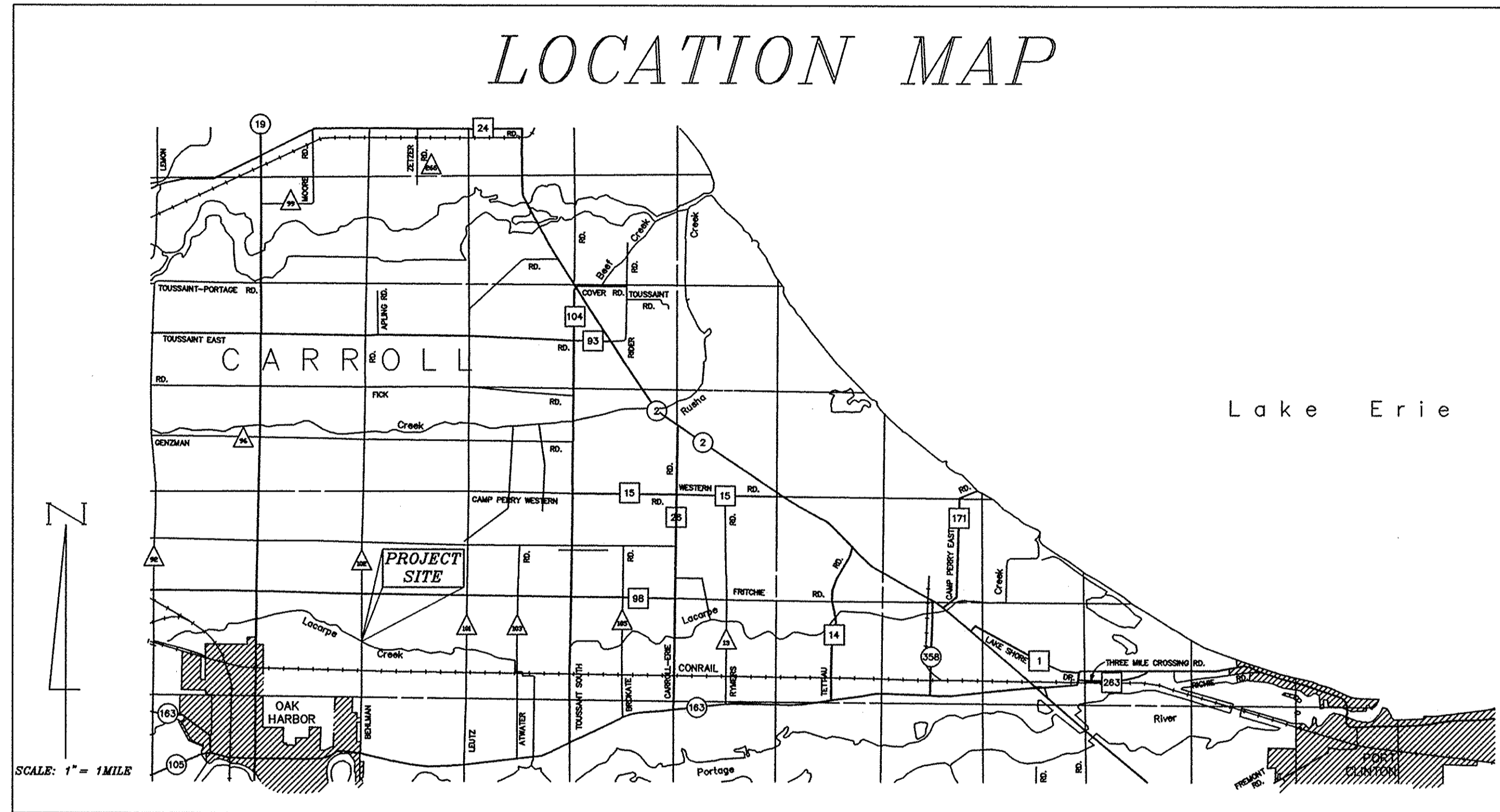

## APPROVALS

WE THE COMMISSIONERS OF OTTAWA COUNTY, IN FORMAL SESSION HEREBY APPROVE THESE PLANS AND CERTIFY THAT THE NECESSARY RIGHT-OF-WAY IS AVAILABLE.

<i>James M. Sass</i>	1-24-12
JAMES M. SASS, COMMISSIONER	DATE
<i>Mark W. Stahl</i>	1-24-2012
MARK W. STAHL, COMMISSIONER	DATE
<i>Steve M. Arndt</i>	1/24/12
STEVE M. ARNDT, COMMISSIONER	DATE

I HEREBY APPROVE THESE PLANS.

<i>David A. Brunkhorst</i> PERS	1/19/12
DAVID A. BRUNKHORST, PE, RS OTTAWA COUNTY ENGINEER	DATE

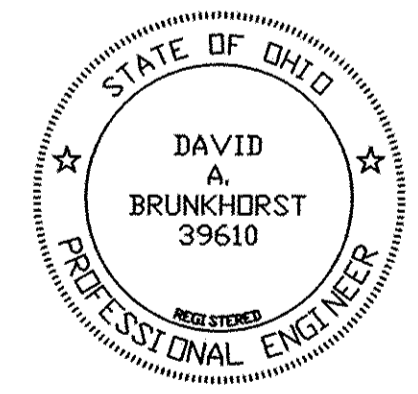
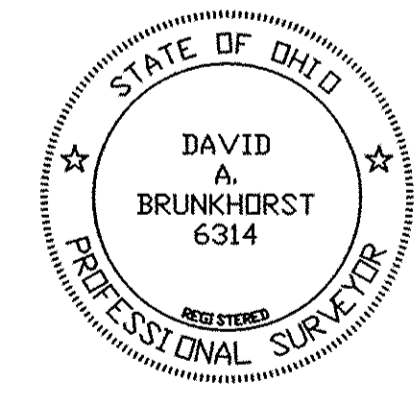

## GENERAL NOTES

- (1) UTILITIES ARE SHOWN TO THE BEST OF OUR KNOWLEDGE. THE CONTRACTOR WILL CONFIRM UTILITY LOCATION BEFORE DOING ANY WORK
- (2) ALL MATERIAL SUPPLIED FOR THIS PROJECT SHALL BE OBTAINED FROM AN O.D.O.T APPROVED SOURCE ONLY.
- (3) OTTAWA COUNTY IS TO MAINTAIN STANDARD BARRICADES AND TRAFFIC CONTROL AT PROJECT SITE.
- (4) LOCAL ACCESS TO RESIDENCES AND BUSINESSES SHALL BE MAINTAINED AT ALL TIMES.
- (5) CONSTRUCTION STAKING AND LAYOUT TO BE PROVIDED BY THE CONTRACTOR.
- (6) REMOVAL OF EXISTING BRIDGE SHALL INCLUDE HEADWALLS, STEEL ARCH, FOOTINGS AND APPURTENANCES.
- (7) EXISTING ASPHALT SHALL BE SAW CUT AT ALL JOINTS AND A JOINT SEALER MEETING 705.04, SHALL BE USED BETWEEN THE EXISTING AND NEW PAVEMENT.
- (8) DESIGN OF 13' X 6' BOX CULVERT SHALL CONFORM TO THE CURRENT REQUIREMENTS OF THE AASHTO LRFD BRIDGE DESIGN SPECIFICATIONS AND SHALL HAVE A STRUCTURAL CAPACITY THAT MEETS OR EXCEEDS HL93 LOADING REQUIREMENTS.
- (9) BOX CULVERT TO BE BACK FILLED AND PROPERLY COMPACTED TO THE TOP OF THE BOX WITH ITEM 304. COST TO BE INCLUDED IN BID ITEM 603, 13' X 6' CONDUIT, TYPE A, 706.05.
- (10) ALL DRAINAGE TILES TAPPED INTO PROPOSED BOX CULVERT ARE TO BE CUT FLUSH WITH INTERIOR WALL OF SAID BOX CULVERT AND GROUTED SOLID.

CALL OHIO UTILITIES PROTECTION SERVICE AT 1-800-362-2764 TWO WORKING DAYS BEFORE YOU DIG

## SPECIFICATIONS

THE STANDARD SPECIFICATIONS OF THE STATE OF OHIO, DEPARTMENT OF TRANSPORTATION, CURRENTLY IN EFFECT, INCLUDING ALL CHANGES AND SUPPLEMENTAL SPECIFICATIONS, SHALL GOVERN THE IMPROVEMENT, UNLESS OTHERWISE NOTED OR EXCEPTED HEREIN.

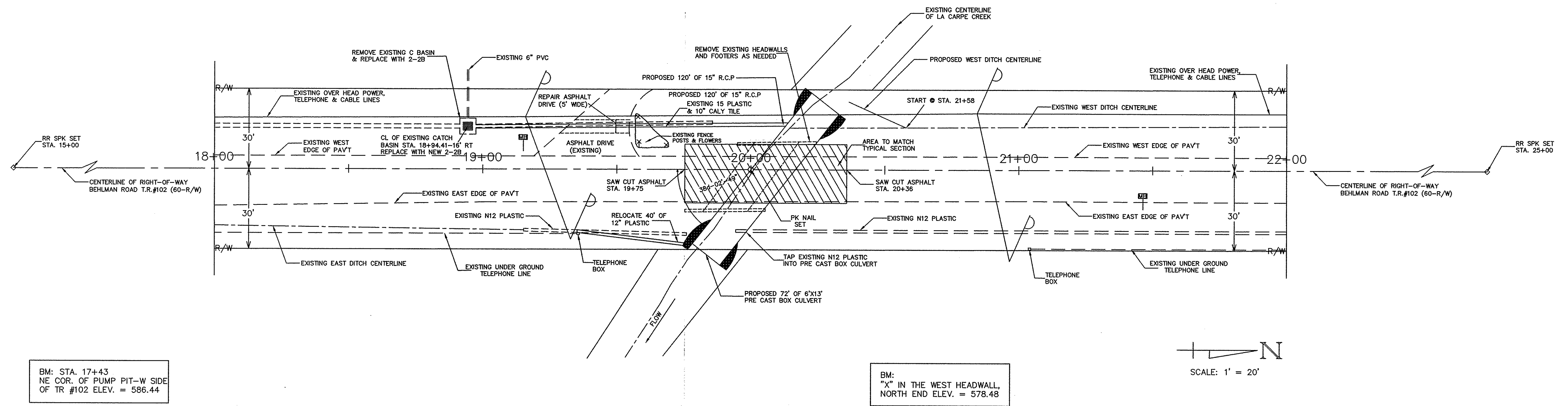

BM: STA. 17+43  
NE COR. OF PUMP PIT-W SIDE  
OF TR #102 ELEV. = 586.44

BM:  
"X" IN THE WEST HEADWALL,  
NORTH END ELEV. = 578.48

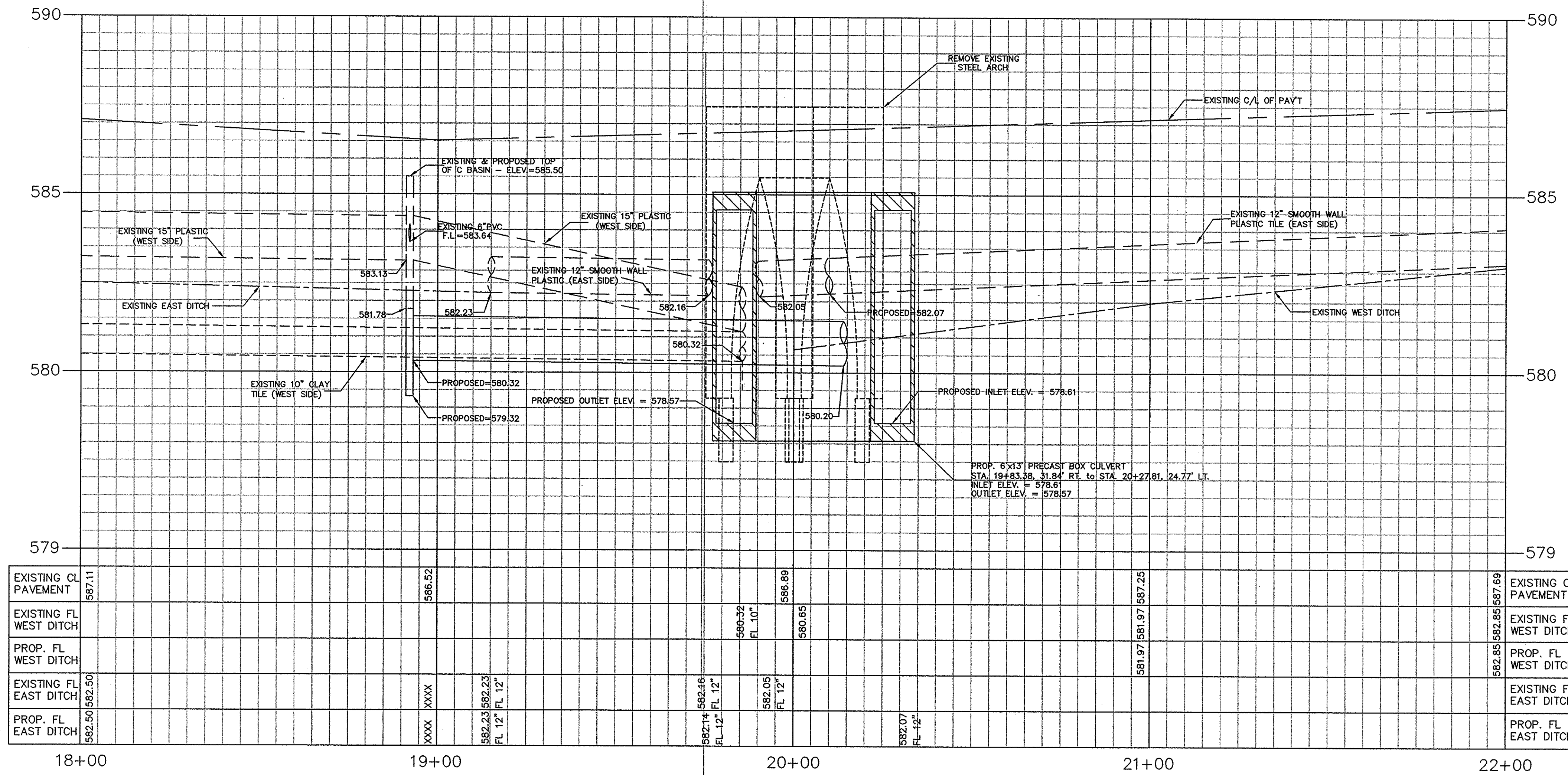
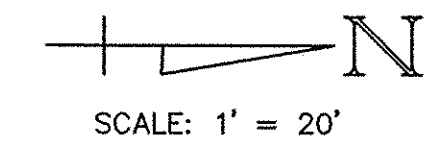

EXISTING CL PAVEMENT	597.11		596.52		596.89		597.25	EXISTING CL PAVEMENT
EXISTING FL WEST DITCH					580.32		581.97	EXISTING FL WEST DITCH
PROP. FL WEST DITCH								PROP. FL WEST DITCH
EXISTING FL EAST DITCH	582.50							EXISTING FL EAST DITCH
PROP. FL EAST DITCH								PROP. FL EAST DITCH

